

Beautiful Ceramic Crystal stone

厦光陶瓷丽晶石



产品简介：

以优质纯丙烯酸乳液为粘剂，采用经过矿酸洗，分级筛选、陶瓷着色、高温煅烧多道工序加工而成的高温烧结砂为骨料，具有附着力强，优异的耐水性、耐久性，抗油污性等优点，高温陶瓷烧结砂，色彩自然持久，色石颗粒均匀，具有自然丽晶石粒装饰效果。

Product features:

High quality pure acrylic emulsion Binder, using pickling after ore, grading, coloring of ceramics, high temperature calcined multichannel working procedure processing high-temperature sinter sand as aggregate, with strong adhesion, excellent water resistance, durability, stain resistance and other advantages, high temperature sintering sand, natural and durable color, color stone granules evenly, with natural beautiful spar size decorative effect.

性能特点：

- 丽晶自然石粒效果
- 色石颗粒均匀
- 优异的抗油污性
- 烧结陶瓷砂，永不褪色
- 附着力强
- 弥盖墙体裂缝
- 色彩自然丰富
- 优异耐久性
- 施工简单，批涂施工

Features:

- Natural grain effects
- Color uniformly
- Resistance to stains
- Sintered ceramic sand
- Strong adhesion
- Masked wall cracks
- Rich in natural colors
- Excellent durability
- The construction is simple



适用场所：

需要展现稳定高贵的建筑物墙面装饰，完成可以装饰出丽晶自然石粒装饰效果。

Application of places:

Need to show stability in noble buildings of wall decoration, complete can decorate a Regent of natural rock, decorative effect.

技术参数：

基料：纯丙烯酸聚合物乳液。
 颜色：样板、色卡或提供来样。
 产品特征：水溶性、彩色、厚质。
 干燥时间：表干12小时，重涂24小时，实干48小时（温度25℃，相对湿度80%）。
 理论耗漆量：2.50~3.50kg/m²，实际视基面粗糙程度，施工方法不同有所差异。

Technical parameters:

Base material: Pure acrylic polymer emulsion
 Color: model, color cards or provide sample
 Product features: Water solubility, colored, thick.
 Drying time: dry for 12 hours, Recoat time 24 hours, work for 48 hours. (Temperature 25°C, relative humidity 80%)
 consumption of paint: 2.50~3.50kg/m², but the actual surface roughness, construction methods varied.

施工：

施工方法：专用批刀批涂。
 稀释比例：不宜加水稀释，以免影响装饰效果。确有需要可酌加5%以内清水稀释。
 施工要求：在5℃ - 35℃及相对湿度80%以下施工。大风、下雨等恶劣天气应避免施工。

Technical parameters:

Construction method: Special knife coating
 Dilution ratio: should not be diluted with water, so as not to affect the decorative effect. Genuine need may be subject to additional 5% less than clear water dilution.
 Construction requirements: 5°C-35°C, relative humidity below 80% construction. Construction of wind, rain and other inclement weather should be avoided.

施工工艺 Construction technology

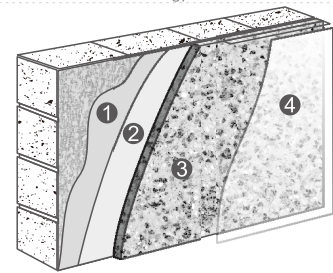

- ① 基层：厦光中层柔性腻子/厦光专用中层腻子2-3道
- ② 底层：厦光含沙专用底漆1道
- ③ 中层：厦光陶瓷丽晶石涂料1道
- ④ 罩面：厦光罩面涂料1道
- ① The grass-roots level: Light Middle flexible PuTTY/Terminal special PuTTY for Middle 2-3 road
- ② Coating: Sediment-specific primer 1
- ③ Main material: HA Kwang Li spar ceramic coating, 1 road
- ④ Overlay: overlay coatings 1

建筑涂料色彩发展历程 Architectural paint color history

